

Features

- Flicker free
- Current adjustable via DIP switch
- Suitable for Class II light fixtures
- 5-year warranty (please refer to the warranty condition)



Applications

· Indoor office lighting · commercial lighting

Descriptions

LF-GIF038YH0900H(FK01) is a 38W indoor lighting LED driver. Its input voltage ranges from 220 to 240Vac and output current is adjustable via DIP switch from 400mA to 900mA. It is suitable for Class II light fixtures, including indoor office light and commercial light.

Product Model

LF - GIF 038 YH 0900H (FK01)

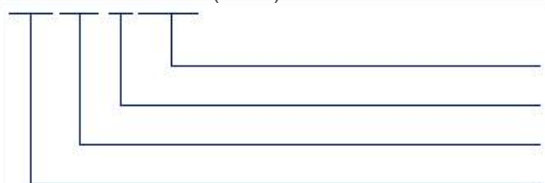

- 0900: output current 900mA; H: input voltage: 220-240Vac
- Y: complies with certifications; H: serial number
- 038: output power: 38W
- G: isolated design; IF: indoor flicker-free version

LiFud Technology Co., Ltd.

Production Base I (HQ): Building B, Kutto Industrial Park, NO.26 Xinhe Road, Bao'an District, Shenzhen, China.

Production Base II: No.4, Block 2, Tengfei Road, Shigao Economic Development Zone, Tianfu New Area, Sichuan, China.

Website: www.lifud.com

Telephone: +86(0)755 8373 9299

Email: sales@lifud.com

■ Electrical Characteristics

Model		LF-GIF038YH0900H(FK01)							
Output	Output Voltage	28-42Vdc							
	Output Current	400mA	480mA	550mA	650mA	700mA	800mA	850mA	900mA
	Flicker Index	Complies with IEEE Std 1789-2015							
	CIE SVM	≤0.4							
	IEC-Pst	≤1.0							
	Current Tolerance	± 7%	± 5%						
	Temperature Drift	± 10%							
	Startup Time	<0.5S@230Vac							
Input	AC Input Voltage	220-240Vac (voltage limit: 198-264Vac)							
	DC Input Voltage	220-240Vdc (voltage limit: 180-264Vdc)							
	Input Frequency	0/50/60Hz							
	Input Current	0.28A max.							
	THD	≤25%			≤20%		≤15%		
	PF	≥0.85		≥0.9					
	Efficiency	≥82%	≥85%	≥86%	≥87%		≥88%		
	Inrush Current	≤28A&150uS@230Vac							
	Loading Quantities of Circuit Breaker	Model	B10		C10		B16		C16
		Quantity (pcs)	20		34		33		56
	Leakage Current	≤0.7mA							
	Standby Power Consumption	≤0.5W							
Protection Characteristics	Open Circuit	<55V							
	Short Circuit	Hiccup mode (auto-recovery)							
Environment Descriptions	Operating Temperature	-30℃ - +45℃							
	Operating Humidity	20-95%RH (no condensation)							
	Storage Temperature/ Humidity	-30℃ - 80℃ (6 months in Class I environment); 0-95%RH (no condensation)							
	Atmospheric Pressure	86-106kPa							

■ Electrical Characteristics

Safety & EMC	Certifications	ENEC, CE, CB, RCM, UKCA
	Withstand Voltage	I/P-O/P: 3.75kV&5mA&60S
	Insulation Resistance	I/P-O/P: >100MΩ@500Vdc
	Safety Standards	ENEC:EN 61347-2-13:2014/A1:2017 EN 61347-1:2015/A1:2021 EN IEC62384:2020 CE:EN 61347-2-13:2014/A1:2017 EN 61347-1:2015/A1:2021 EN 62493:2015 CB:IEC61347-1:2015 IEC61347-1:2015/AMD1:2017 IEC61347-2-13:2014 IEC61347-2-13:2014/AMD1:2016 UKCA-LVD:EN 61347-1:2015/A1:2021, EN 61347-2-13:2014/A1:2017 EN 62493:2015 RCM:AS 61347.2-13:2018
	EMI	CE-EMC: EN55015, EN61000-3-2, EN61000-3-3 UKCA-EMC: EN IEC 55015: 2019/A11: 2020, EN 61547: 2009, EN IEC 61000-3-2: 2019/A1: 2021, EN 61000-3-3: 2013/A2: 2021
	EMS	CE-EMC: EN61000-4-2, 3, 4, 5 (lightning strike 1kV), 6, 11
Other Parameters	IP Rating	IP20
	RoHS	RoHS 2.0 (EU) 2015/863
	Warranty	5 years (Tc≤69℃)
Test Equipment	AC power source: CHROMA6530, digital power meter: CHROMA66202, oscilloscope: Tektronix DPO3014, DC electronic load: M9712B, LED board, constant temperature and humidity chamber, lightning surge generator: Everfine EMS61000-5B, rapid group pulse generator: Everfine EMS61000-4A, spectroanalyzer: KH3935, Hi-pot tester: EEC SE7440, flicker tester (flicker-free coefficient test) Everfine LFA-3000, etc.	
Test Remark	If there are no special remarks, the above parameters are tested at the ambient temperature of 25℃, humidity of 50%, full load and input voltage of 230Vac/50Hz.	

Electrical Characteristics

Additional Remarks	<ol style="list-style-type: none"> 1. It is recommended that user install over voltage protection, under voltage protection and surge protection devices in the power supply circuits of light fixtures to ensure electricity safety. 2. The LED driver used in combination with the end device is one of the accessories of the whole light fixture, and the EMC of the whole light fixture is not only susceptible to the driver itself, but to the LED light fixture and the whole light fixture's wiring. Thus, the manufacturer of LED light fixture should re-confirm the EMC of the whole light fixture before the whole light fixture is finished. 3. The test conditions of the circuit breaker configuration quantity are the same as those of the inrush current. 4. The PC cover, casing and end cap for assembling the LED driver in the light fixture must meet the fire rating of UL94-V0 or above.
---------------------------	--------------------------------------------------------------------------------------------------------------------------------------------------------------------------------------------------------------------------------------------------------------------------------------------------------------------------------------------------------------------------------------------------------------------------------------------------------------------------------------------------------------------------------------------------------------------------------------------------------------------------------------------------------------------------------------------------------------------------------------------------------------------------------------------------------------------------------------------------------------------------------------------------------------------------------------------------------------

Product Characteristic Curves

PF Curve

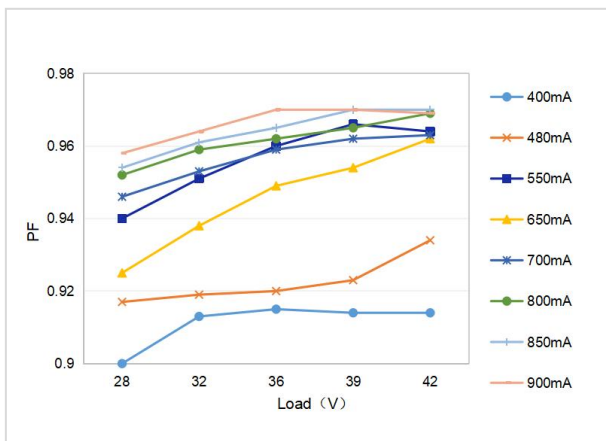

Efficiency Curve

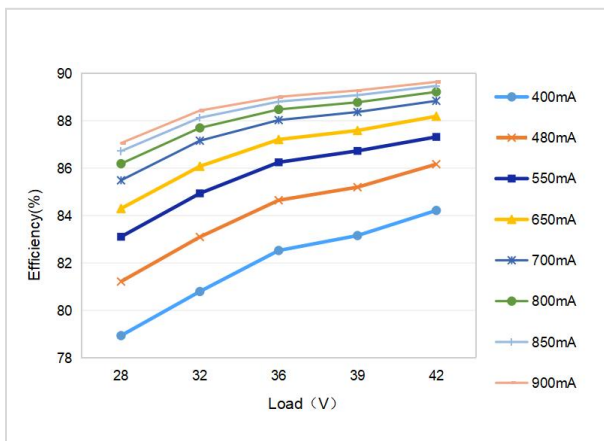

Lifetime Curve

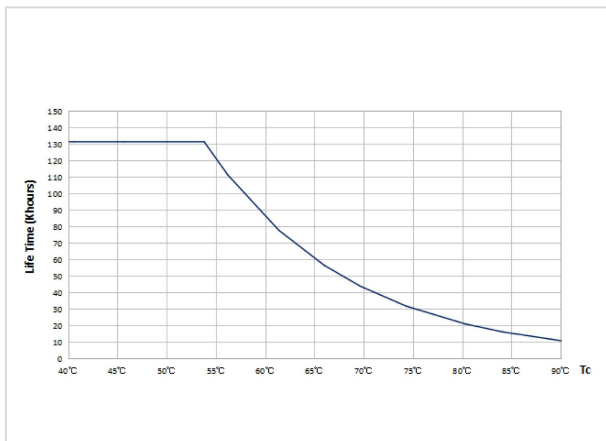

Tc Point Test Diagram

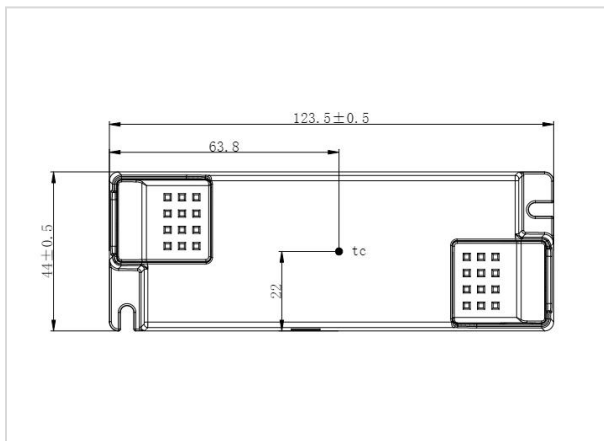

■ Product Definitions

Product Terminals

INPUT		OUTPUT	
AC-L	AC live wire input	LED+	Positive electrode output of LED driver
AC-L	AC live wire input	LED-	Negative electrode output of LED driver
AC-N	AC neutral wire input		
AC-N	AC neutral wire input		

Product DIP Switch

LF-GIF038YH0900H(FK01)			
I rated (CC)	1	2	3
400mA	-	-	-
480mA	ON	-	-
550mA	-	ON	-
650mA	ON	ON	-
700mA	-	-	ON
800mA	ON	-	ON
850mA	ON	ON	-
900mA	ON	ON	ON

Remark: "-": shift OFF

■ Structure & Dimensions (unit: mm)

Model	Overall Appearance (L*W*H)	Distance Between 2 Positioning Holes (L)	Diameter of Positioning Hole (D)
LF-GIF038YH0900H(FK01)	123.5*44*28.5 mm (±0.5 mm)	113.5 mm (±0.2 mm)	3.7 mm

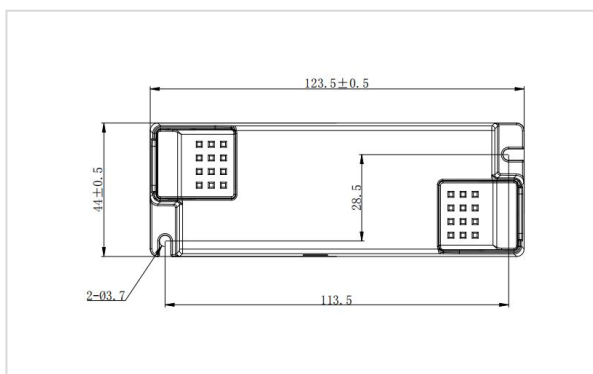
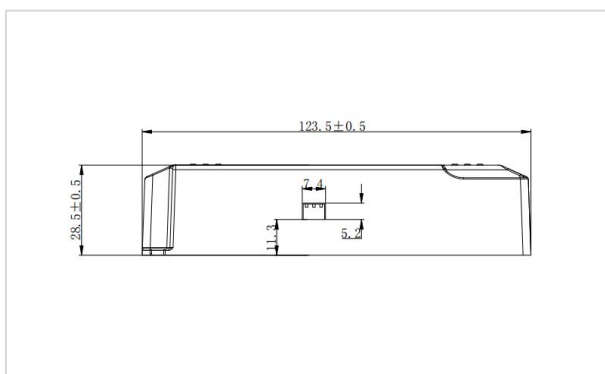

■ Packaging Specifications

Model	LF-GIF038YH0900H(FK01)
Carton Size	385*285*210 mm (L*W*H)
Quantity	12pcs/layer; 6layers/ctn; 72pcs/ctn
Weight	0.1 kg \pm 5%/pc; 7.89 kg \pm 5%/ctn

■ Transportation & Storage

1. Transportation

- Suitable transportation means: vehicles, boats and aeroplanes.
- In transit, it is necessary to prepare awnings for rain or sun protection. Moreover, please keep civilized loading and unloading to prevent the vibration or impact of LED driver as much as possible.

2. Storage

- The storage of LED driver shall conform to the standard of Class I environment. When using LED drivers which have been stored for more than 6 months, please re-test them firstly. Do not use them unless they are tested to be qualified.

Cautions

- Please use Lifud LED driver according to its parameters in the specification, otherwise the LED driver may malfunction.
- Using any incompatible light fixtures or those that have not been certified may cause fire, explosion or other risks.
- Man-made damage is beyond the scope of Lifud warranty service.

Remark: Lifud Tecnology Co., Ltd. reserves the right to interpret any contents of this specification.